

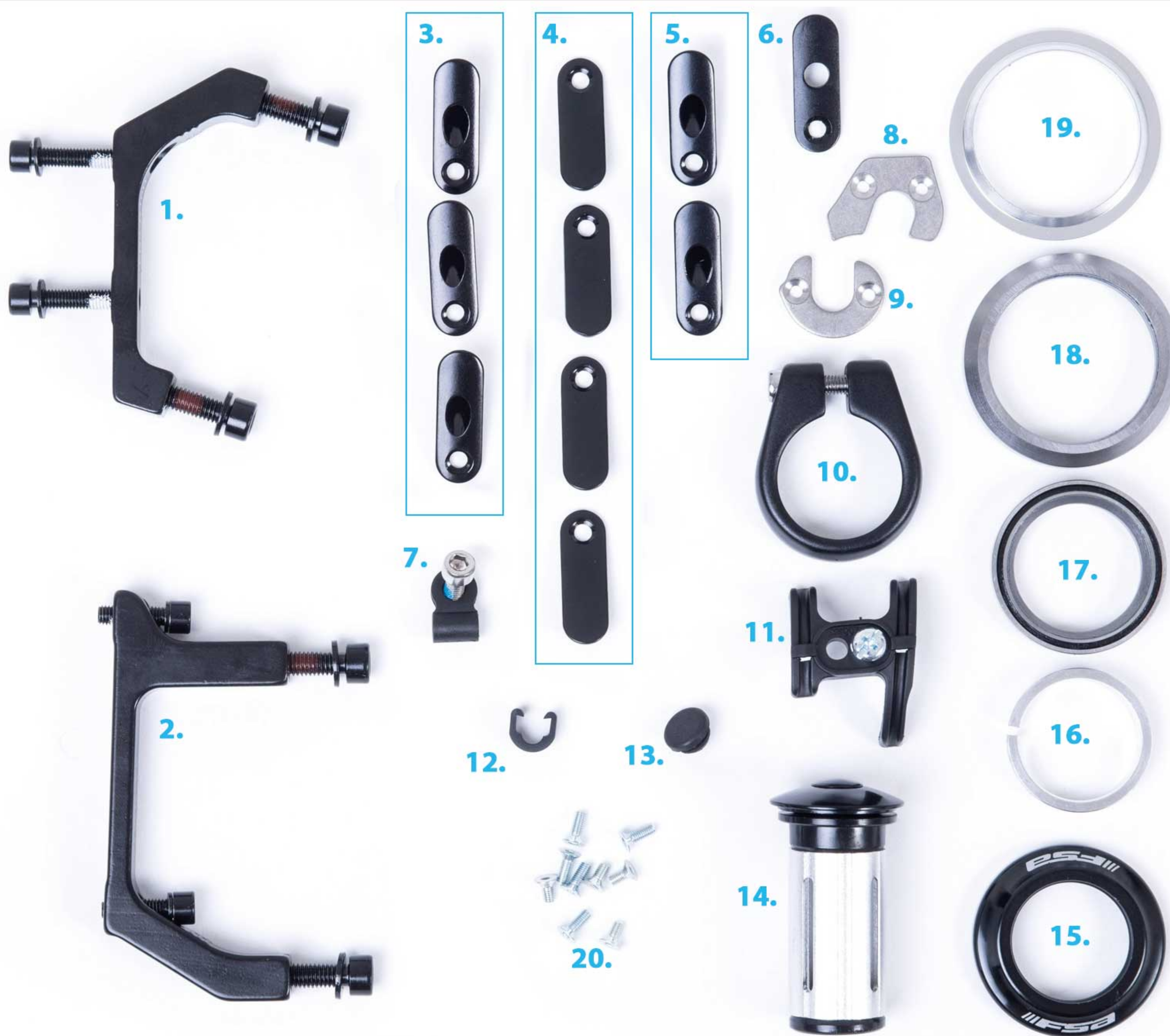

RACELIGHT 4SDISC – FRAME PARTS KIT



1. REAR FLAT-TO-POST MOUNT ADAPTER – 2x fitting bolts, 2x caliper bolts (some frames come with 140mm & 160mm adapters)
2. FRONT FLAT-TO-POST MOUNT ADAPTER – 2x fitting bolts, 2x caliper bolts (some frames come with 140mm & 160mm adapters)
3. 3x CABLE GUIDE PORTS – 2.5mm port size for gear cable inner
4. 4x BLANKING PORTS – When running disc brakes and 1x setups
5. 2x BRAKE GUIDE PORTS – 5.7mm port size for hose/cable outer
6. Di2 CABLE PORT – for drive side downtube when running Di2
7. DISC BRAKE HOSE GUIDE AND BOLT – for inside of chainstay
8. DROPOUT ADAPTER FOR 130mm RIM WHEEL – drive side
9. DROPOUT ADAPTER FOR 130mm RIM WHEEL – non-drive side
10. SEAT CLAMP
11. UNDER BB CABLE GUIDE AND BOLT
12. DISC BRAKE HOSE CLIP – for disc brake inside of chainstay
13. Di2 BLANKING PLUG – for seat tube
14. FORK STEERER BUNG
15. HEADSET BEARING CAP
16. TOP BEARING PRELOADING WEDGE
17. HEADSET TOP BEARING
18. HEADSET LOWER BEARING
19. CROWN RACE – if needed (forks have integrated crown race so this is not needed)
20. FITTING BOLTS – 4x 5.8mm for dropout adapters, 5x 7.9mm for cable ports